

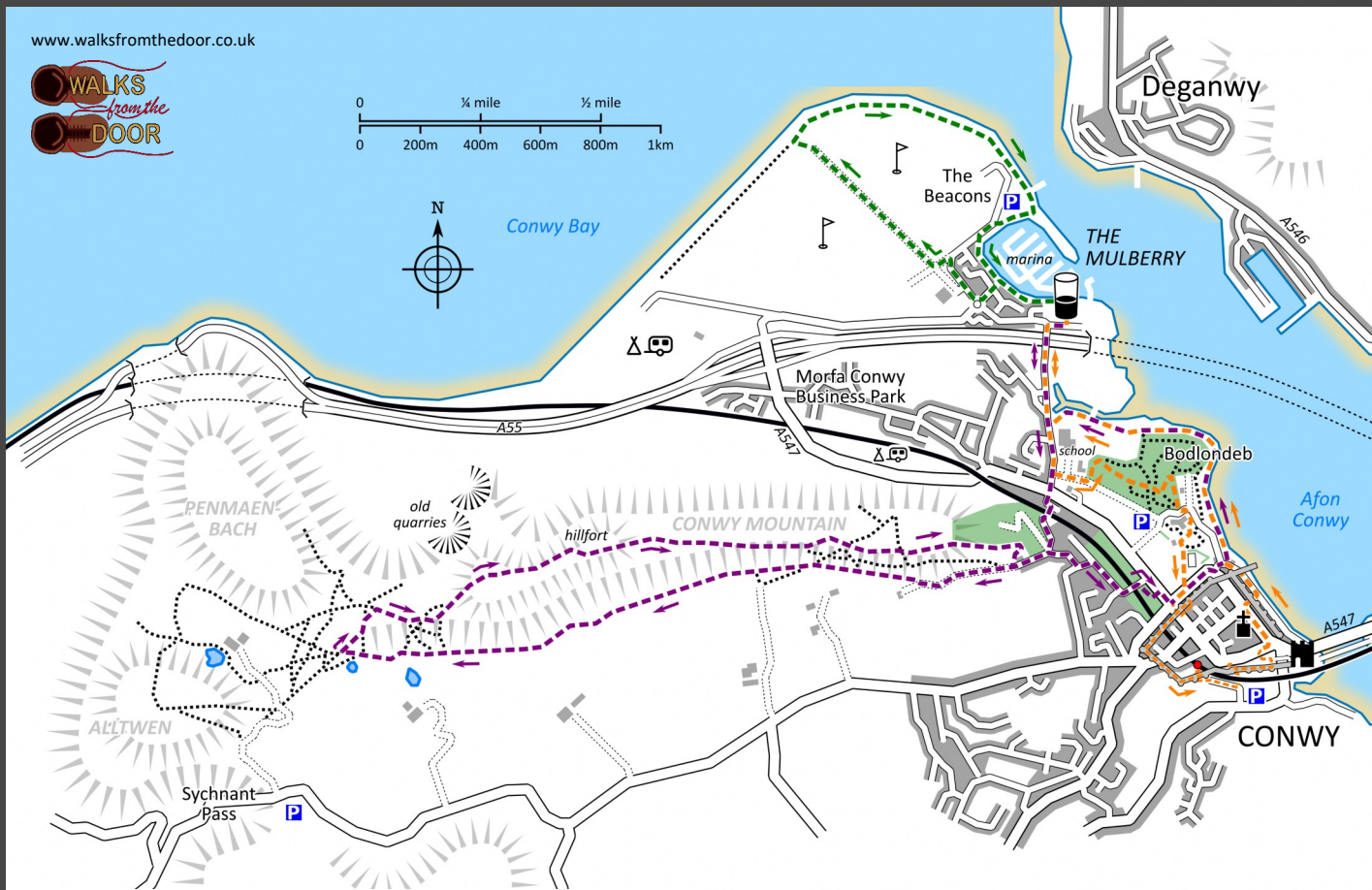

0 ¼ mile ½ mile
0 200m 400m 600m 800m 1km



Castell Caer Seion on the summit of Conwy Mountain has been dated to the 6th century BC. It actually consists of two hillforts, the smaller, later one built inside the larger, earlier one. Within the fort are the remains of up to 50 roundhouses, though their outlines are not easily seen by the untrained eye.



Great Orme from Morfa Conwy



Conwy Town Walls were constructed in the 1280s and have been described as "one of the most impressive walled circuits in Europe".



Conwy Marina shelters up to 500 boats, and has fine views across the Conwy estuary. The Mulberry Harbours used in the D Day landings were partly developed here, and the area was used as a dry dock area during the building of the Conwy Tunnel in 1986–91, at the time the UK's most expensive road project.

THREE CIRCULAR WALKS FROM *The Mulberry*

CONWY MARINA



MORFA CONWY 1¾ miles

CASTLE & TOWN WALLS 2¾ miles

CONWY MOUNTAIN 5 miles



ROBINSONS

Morfa Conwy (1¾ miles: Easy)

Allow 1–1½ hours. Sandy paths, and wet grass after rain.

1 Walk out to the marina and turn left. **2** After 250 yards, by a shelter, leave the water's edge, turning left into the houses (signposted 'Golf Course'). **3** Cross Mulberry Close and take the road straight on, to a mini-roundabout. **4** Turn right along Beacons Way, passing the entrance to the golf club on the left. **5** When the road bends right, turn left by a gate onto the golf course. **6** Walk past a hut to a crossroads of paths and turn right. **7** Follow the broad track across the course until you reach the strip of sand dunes above the beach. **8** Pick up a path by a concrete structure (part of a former rifle range) and turn right. **9** Follow the path between the beach and the golf course as it curves inland along the estuary. **10** Pass a car park on your right and continue past a jetty. **11** When you reach the marina, turn right along a path to the road. **12** Follow the pavement to the first house. **13** Turn left and walk alongside the marina back to The Mulberry.

Castle & Town Walls (2¾ miles: Moderate)

Allow 2 hours. Mostly on surfaced paths and roads, but woodland paths may be muddy. The town walls are occasionally uneven, include numerous steps and in places require a head for heights.

1 From the car park, walk out to Ellis Way and turn right then immediately left into Morfa Drive. Cross the bridge over the A55 with a view of the tunnel portals. Pass the end of a tidal creek and continue, beyond a cattle grid, along the road past the school. **2** Just beyond the school buildings, turn left between school and car park. **3** Follow the track between wall and fence beyond the zebra crossing for a short distance, then turn left onto a path into the wood that runs to the right of a stone barn. **4** At the point where the path starts to descend, turn right onto a path heading uphill into the wood. **5** Towards the top of the hill, you meet another path by an orienteering waymark post; turn left. **6** Climb a flight of five steps and go straight on over a crossing path, following the blue trail marker. **7** At the next junction, bear left, still following the blue waymarks. **8** Take a right-hand turn, again indicated by a blue waymark. **9** This path leads down to the council offices; turn left and then immediately right on a tarmac path across the lawns in front of the main building, then follow the path round to the right. **10** Bear left to a litter bin at the rear of the cricket pavilion and take the path (signposted to the Castle and Town Centre) running to the right of some tennis courts, which leads to Town Ditch Road. **11** Cross and turn right and then, at the road junction, turn left through the arch in the town wall. **12** Turn immediately left into a narrow alley giving access to a wooden staircase onto the wall. **13** Climb the stairs and turn left along the top of the wall. **14** Pass two bastions and climb to the tower in the corner

at the highest point on the wall. **15** Continue along the wall, crossing Upper Gate Street and passing further bastions until you are forced to leave the wall, via a staircase within a tower, by the railway. **16** At the foot of the stairs, turn left and then left again through an archway. **17** Turn left and walk down to Morfa Bach car park, where you turn left through the subway beneath the railway line. **18** At the far end, turn left up the steps and pass through the Mill Gate ahead. **19** Turn right and then immediately right again, through a stone doorway into the tower, and climb the stairs to return to the top of the wall. **20** Walk along the wall towards the castle past two more bastions, then descend from the wall via the staircase in the third. The ticket office for the castle is on your right. **21** To continue, bear left across the car park and exit into Rose Hill Street opposite St John's Methodist Church. **22** Turn right, then left into Castle Street. **23** By Aberconwy House, turn right and walk down through the Lower Gate to the quayside. **24** Turn left past the "Smallest House in Wales" and continue through the Wing Arch at the end of the row of cottages. **25** Follow the road round to the left, then turn right onto the Marine Walk. **26** Follow the tarmac path along the edge of the estuary for a third of a mile, and stay on it as it bears left alongside a creek and past a footbridge connecting the school and its playing field. **27** On reaching Morfa Drive, turn right and retrace your steps over the A55 back to Ellis Way, where you turn right to return to The Mulberry.

Conwy Mountain (5 miles: Fairly strenuous)

Allow 3 hours. Gradual ascent and some rocky ground. May be muddy or boggy in places.

1 From the car park, walk out to Ellis Way and turn right then immediately left into Morfa Drive. Cross the bridge over the A55 with a view of the tunnel portals. Pass the end of a tidal creek and continue, beyond a cattle grid, along the road past the school. **2** Cross the A547 into the road opposite (The Waen) and cross the footbridge over the railway. **3** Follow the walled lane ahead, passing the entrance to Beechwood Court. **4** At a T-junction, turn right (Mountain Road). **5** Climb to a fork by a parking area, where you carry straight on along the lower track; ignore a stile and sign for Conwy Mountain on your right. **6** When the road reaches the entrance to a house, take the track through the gate on the right, which continues to climb gradually alongside a wall. **7** When the wall ends, cross an oblique path and follow the path opposite, continuing to ascend gradually. **8** The track continues upwards with views up the Conwy valley before emerging into open country and then following a wall on the left. **9** The path descends slightly and rounds a boggy area above a pond in the fields to your left, then leaves the wall to strike out across the moorland. **10** When the path again descends slightly to a rushy pond to the left of the track, turn sharp right at a waymark post (with discs for the Wales Coast Path and North Wales Path) and follow a path between the gorse and heather. **11** On meeting a grassy path, bear left in the

direction of the distant Great Orme headland. **12** Take a right fork towards a lone tree, where you meet a major path by another waymark post. **13** Turn right and follow the stony path to the top of the ridge, with superb views over the quarries to the Great Orme. **14** Keep left at a waymark post and climb a rocky knoll (where the path divides briefly). **15** After a more level section, the path climbs again to another rocky outcrop. **16** Staying on the main ridge path, the next landmark is the hillfort of Castell caer Seion. **17** After a further rocky knoll beyond the hillfort, the path descends and becomes generally grassier. **18** Staying always along the highest path, after rounding a rocky slab used by a climbers, ignore a path leading off to the left to a rocky pinnacle overlooking Morfa Conwy. **19** Continuing down the main ridge through bracken, the path eventually meets a fence and then runs along a wall above woodland, until you reach a private doorway in a corner. **20** Turn right here, and follow the path past some small quarries to a stile, and then down to Mountain Road. **21** Turn left down the lane and retrace your steps for a short distance. **22** At a junction keep right, descending before climbing to a T-junction. **23** Turn left along Cadnant Park and follow the road round to the right when it meets the railway line. **24** Turn left over the narrow railway bridge, then turn right onto a path within a belt of trees next to the main road. **25** This path joins the main road through a gap in the wall by a bench. **26** Follow the main road until you meet the town wall. (If you wish to extend your walk to include a circuit of the town walls, go through the archway ahead and join the **Castle & Town Walls** walk at step 12.) **27** Otherwise, turn left down Town Ditch Road, keeping to the left-hand pavement. **28** Before the main road swings right through the wall, turn left into Lower Gate Street. **29** Stay on the road as it bends right and downhill, ignoring the driveway ahead between the gateposts by the half-timbered lodge. **30** In front of a house called Glan-yr-Afon, turn left onto the Marine Walk. **31** Follow the tarmac path along the edge of the estuary for a third of a mile, and stay on it as it bears left alongside a creek and past a footbridge connecting the school and its playing field. **32** On reaching Morfa Drive, turn right and retrace your steps over the A55 back to Ellis Way, where you turn right to return to The Mulberry.

THE MULBERRY

Conwy Marina, Ellis Way, Conwy LL32 8GU

email info@mulberryconwy.pub
web www.mulberryconwy.pub
tel 01492 583350

Opening times

Mon–Thu 11:30am–10:30pm
Fri 11:30am–11:30pm
Sat 10:00am–11:30pm
Sun 10:00am–10:30pm

Food service

Mon–Thu 12:00am–8:00pm
Fri 12:00am–9:00pm
Sat 10:00am–9:00pm
Sun 10:00am–8:00pm